



Vehicle

System

Repair Group

Previous Topic

Next Topic

Technical
Bulletins

Wiring Diagrams

Warnings &
Cautions

Print

Search

Advanced
Search

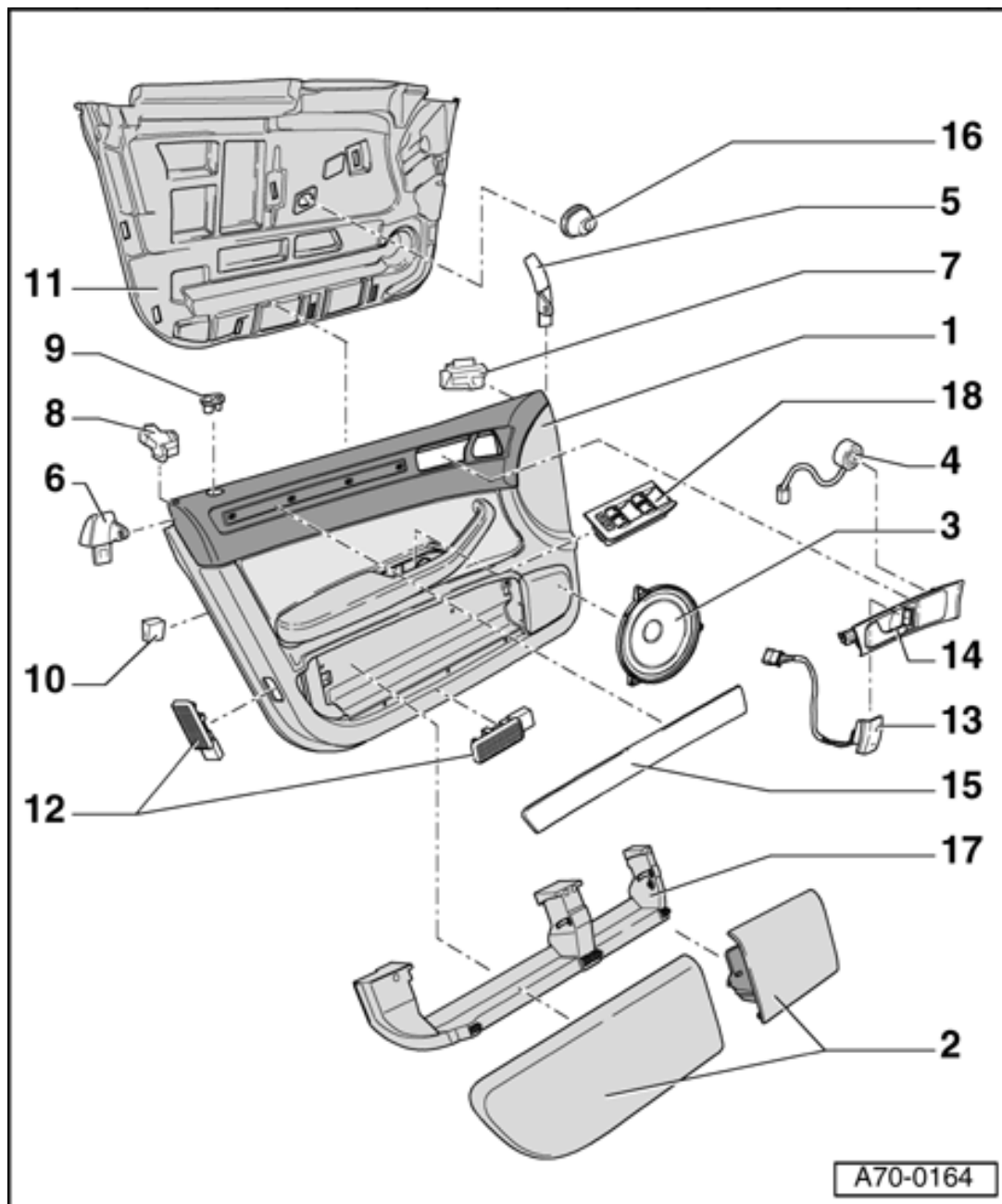
Version: 2.5r01sp0003

A70-0164

Front door trim

Component locations, overview

1 - Door trim

Removing ⇒ [Page 70-3](#)

2 - Hinged pockets

Removing ⇒ [Page 70-16](#)

3 - Loudspeaker

Removing ⇒ [Page 70-15](#)

4 - Treble loudspeaker

Removing ⇒ [Page 70-14](#)

5 - Inner connecting piece

6 - Outer connecting piece

7 - Inner filler piece

8 - Outer filler piece

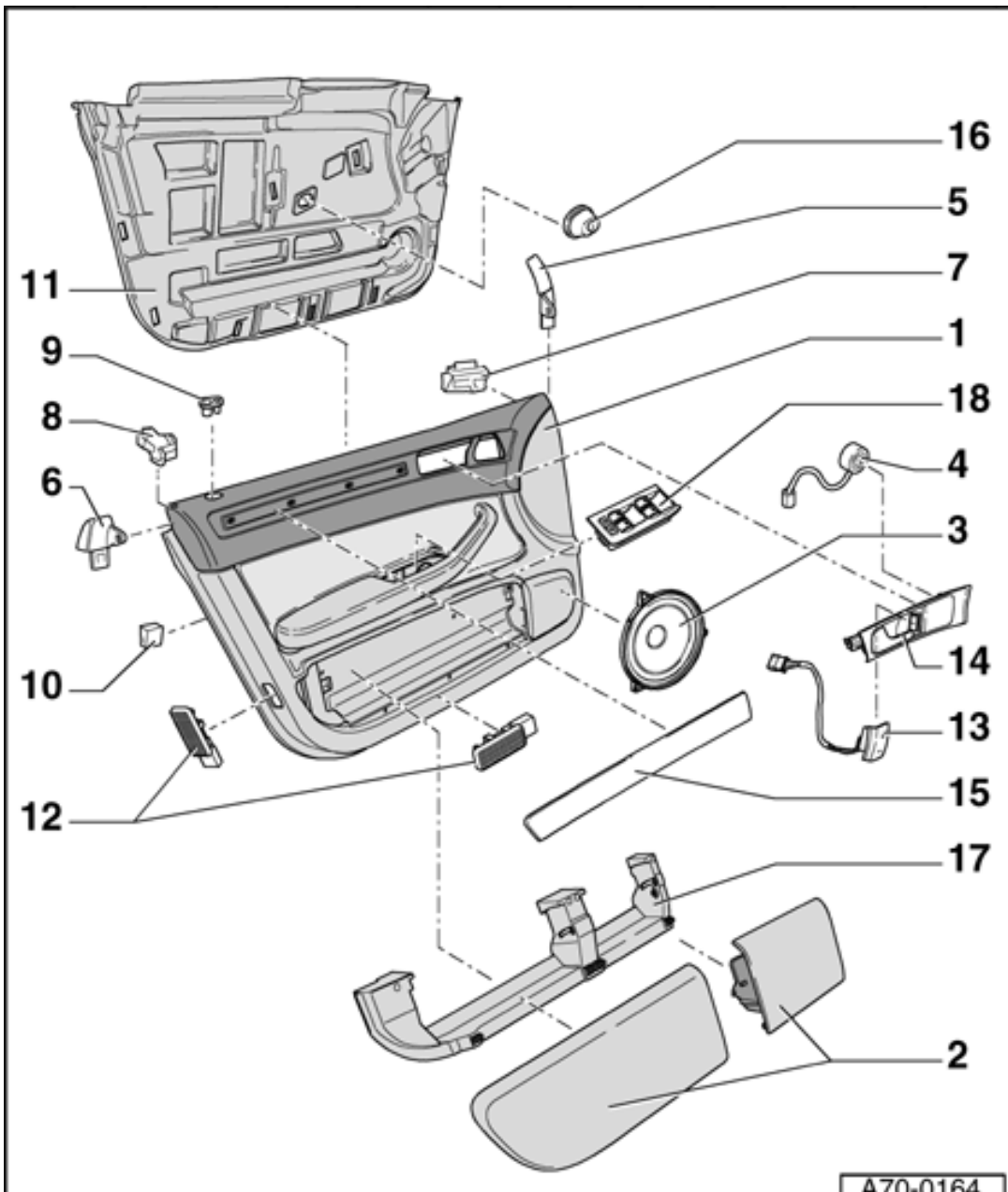

A70-0164

9 - Guide for locking knob

10 - Clip locator

11 - Insulation

Removing and installing ⇒ [Page 70-10](#)

12 - Door warning light

Removing ⇒ [Page 70-13](#)

13 - Central locking switch (driver's side only)

Removing ⇒ [Page 70-26](#)

14 - Interior door handle

Removing ⇒ [Page 70-28](#)

15 - Trim panel

Removing ⇒ [Page 70-27](#)

16 - Foam seal

**17 - Mount for hinged
pockets**

**18 - Window regulator
switch unit**

◆ Driver's side ⇒
[Page 70-6](#)

◆ Passenger side ⇒
[Page 70-8](#)



Front door trim, removing and installing

1 - Door trim

- Remove screws - 2- (2x) from door trim -1-.
- Remove window regulator switch unit -5-.

◆ Driver's side ⇒
[Page 70-6](#)

◆ Passenger side ⇒
[Page 70-8](#)

- Lift door trim about 20 cm upward and remove from door.
- Detach Bowden cable for interior door handle ⇒
[Fig. 1](#) .

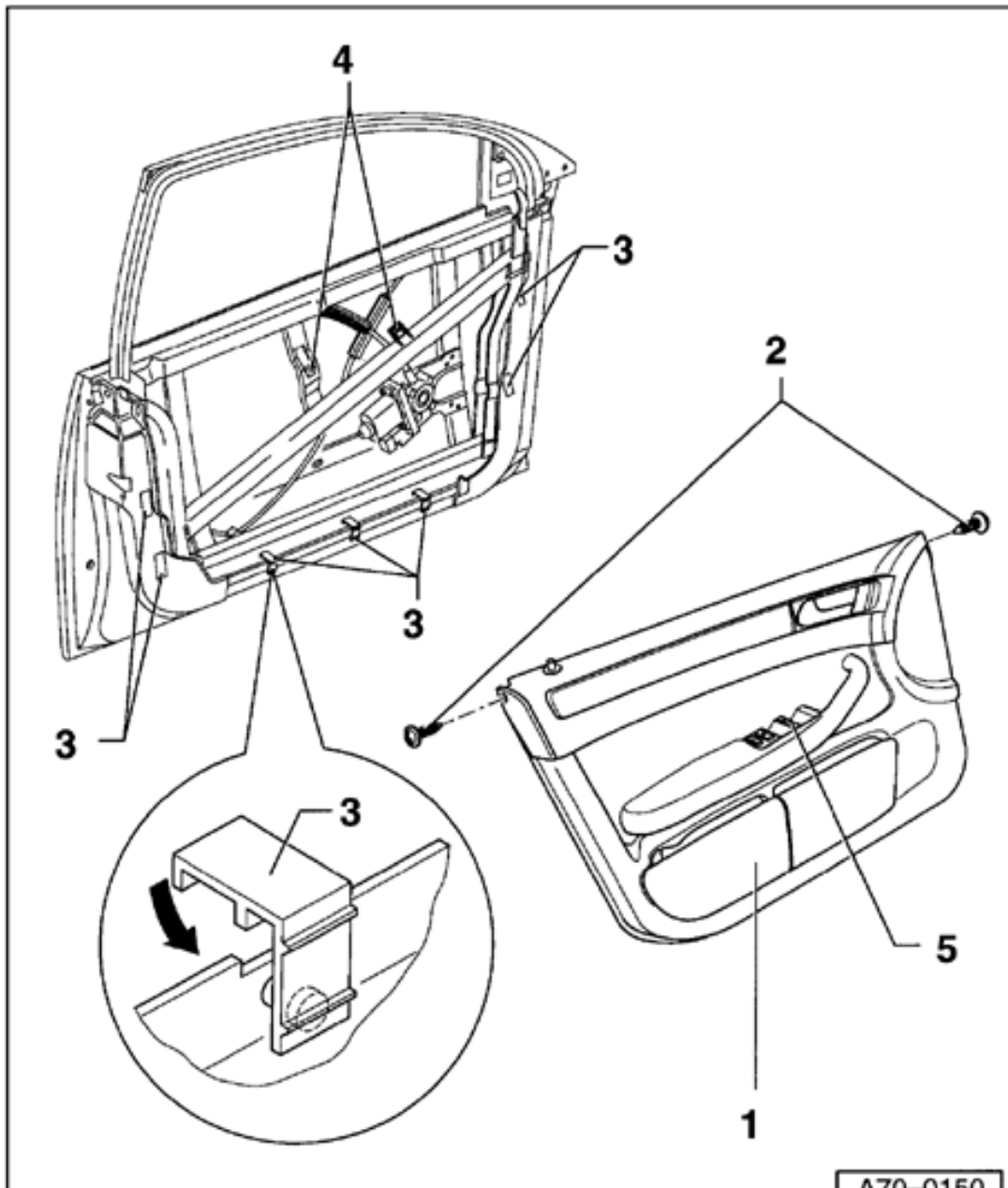

- Disconnect
electrical
connectors ⇒
[Fig. 2](#) .

Clip locators -3- (7x) and -4-
(2x) must be clipped in place
when installing door trim.

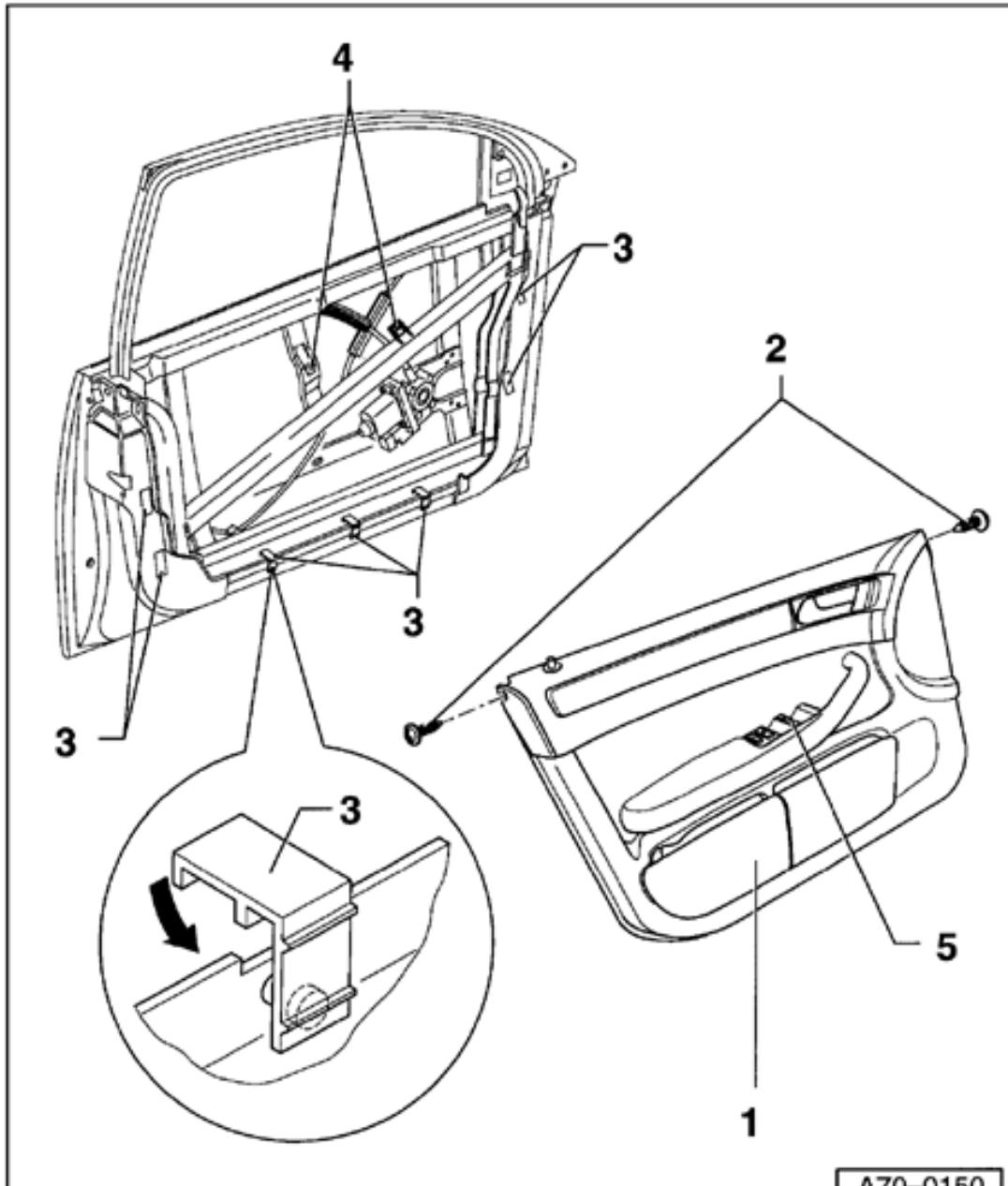

When installing, press center of door trim onto door.

2 - Screws (2x)

- ◆ Tightening torque:
1.5 Nm (13 in lb)

3 - Clip locators

4 - Clip locators

**5 - Window regulator
switch unit**

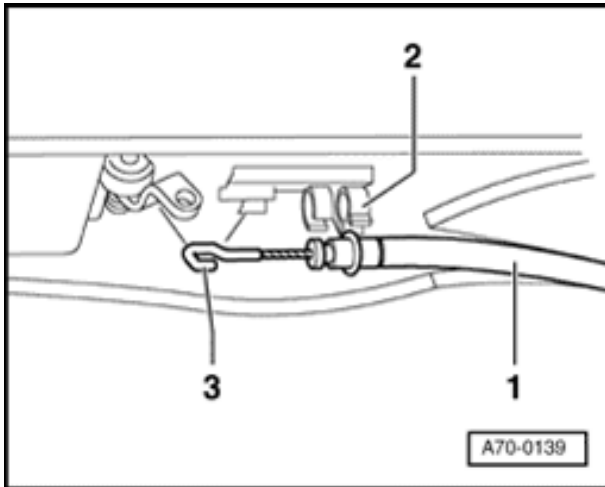

Fig. 1 Detaching Bowden cable

- Pull Bowden cable -1- out of guide -2- and detach.

Note:

When installing, make sure hook -3- is facing upward

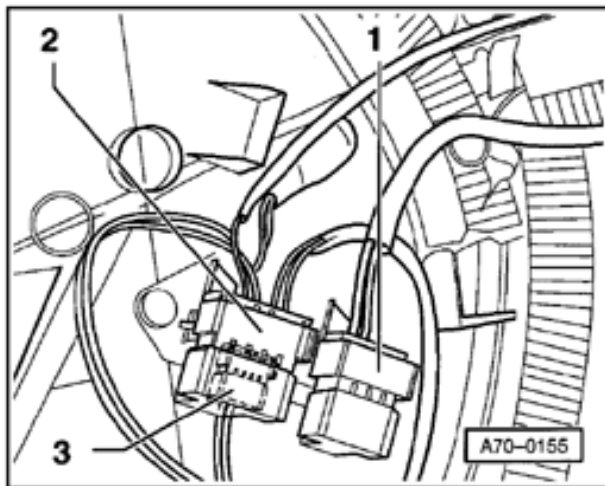
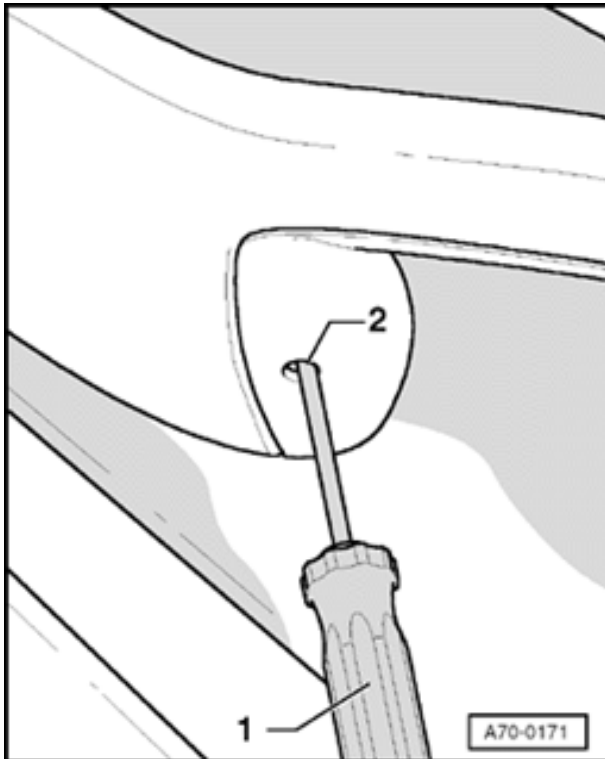

Fig. 2 Disconnecting electrical connectors

- Disconnect connector for central locking switch - 1-.
- Disconnect connector for door warning light and anti-theft alarm -2-.
- Disconnect connector for loudspeaker - 3-.



Driver's window regulator switch, removing and installing



- Insert screwdriver -1- in hole - 2-.

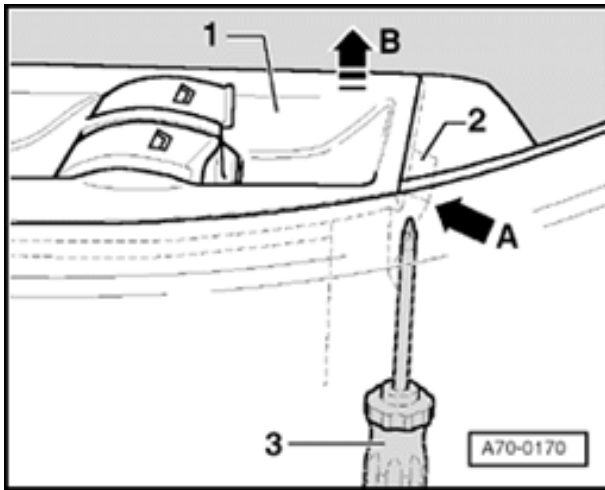

- Use screwdriver -3- to press retainer -2- in direction of arrow -A-.
- Remove window regulator switch unit -1- in direction of arrow -B-.

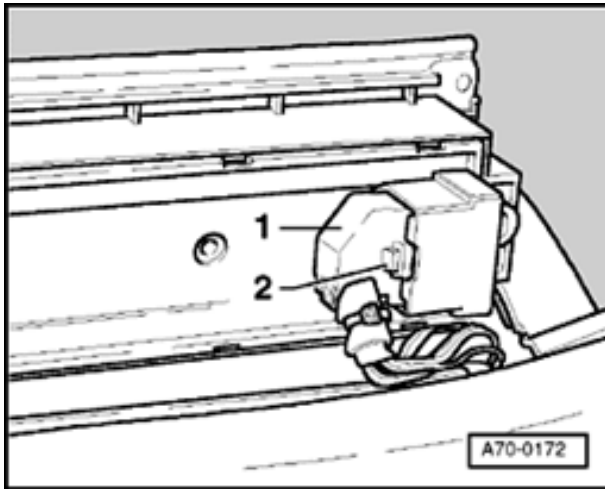

- ⚡ - Press retainer tab -2- and pull off connector -1-.



Front passenger window regulator switch, removing and installing

For vehicles with hole on underside:

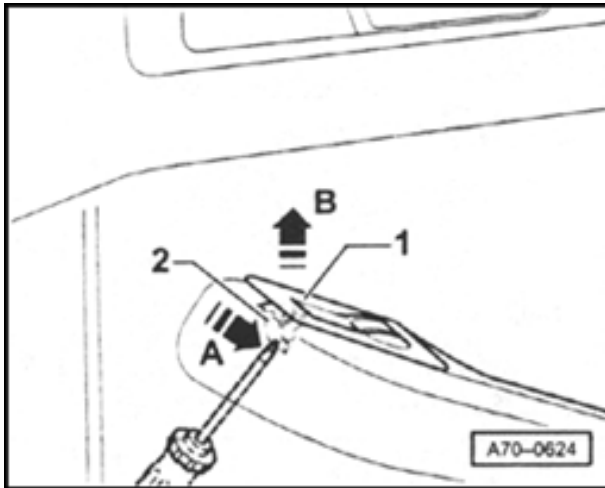

- Insert screwdriver -3- in hole.
- Use screwdriver -3- to press retainer -2- in direction of -arrow A-.
- Remove window regulator switch unit -1- in direction of -arrow B-.

For vehicles without hole on underside:

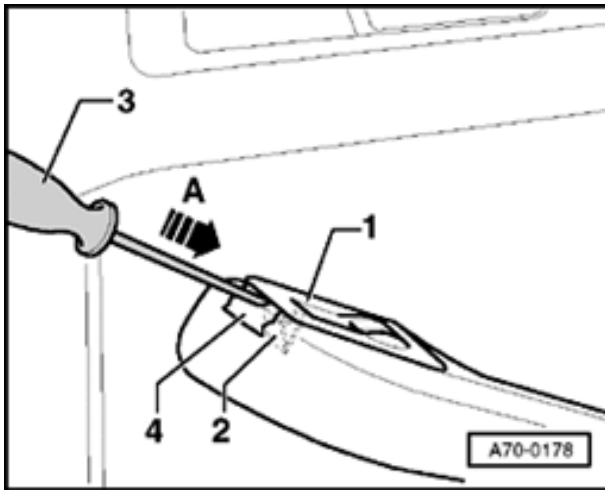

- Mask door trim with adhesive tape - 4-
- Use screwdriver -3- to press retainer -2- in direction of -arrow A-
- Remove window regulator switch unit -1- in direction of arrow.

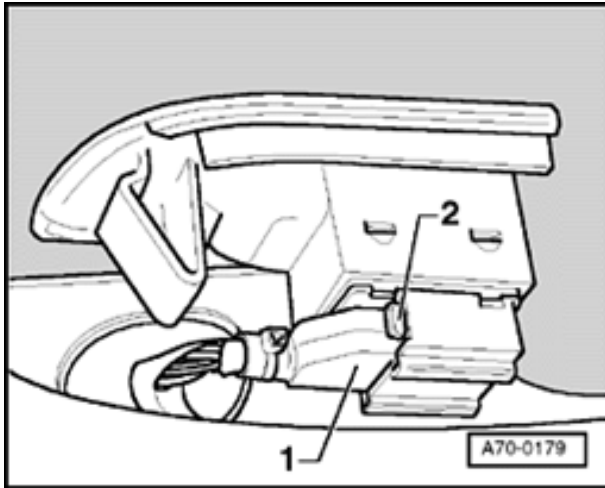
**All vehicles:**

- Press retainer tab -2- and disconnect connector -1-.



Front door trim insulation, removing and installing

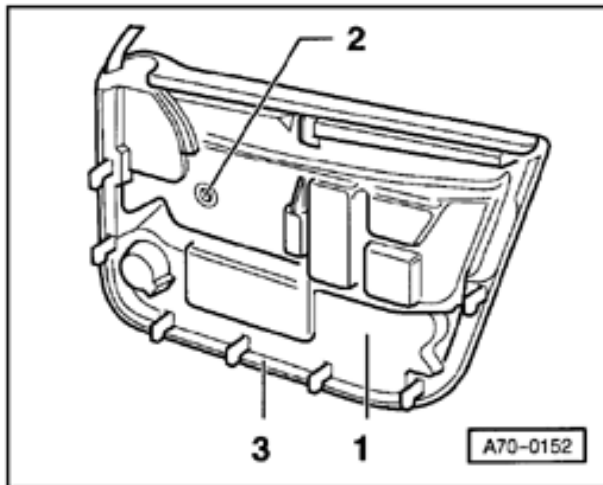

- Insulation -1- must be installed all around inside door trim.
- When removing or installing, make sure insulation -1- is not damaged by clip locators or electrical connectors.
- Wiring cover -2-
- Press on insulation around sealing lip -3-.



Locking knob, adjusting

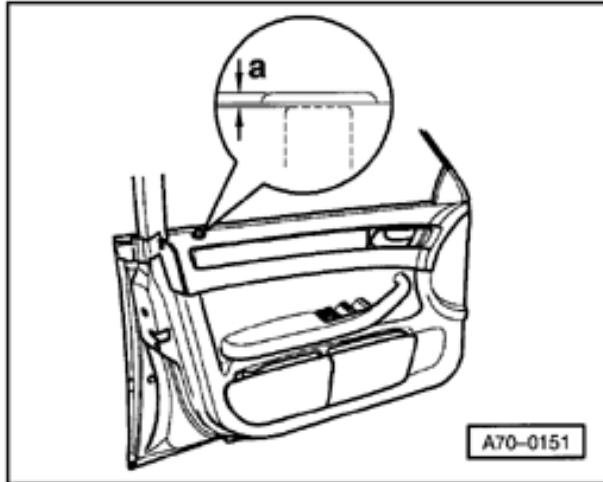

- When in "locked" position, locking knob must not project from door trim (distance -a- = 0 to 2 mm below surface).

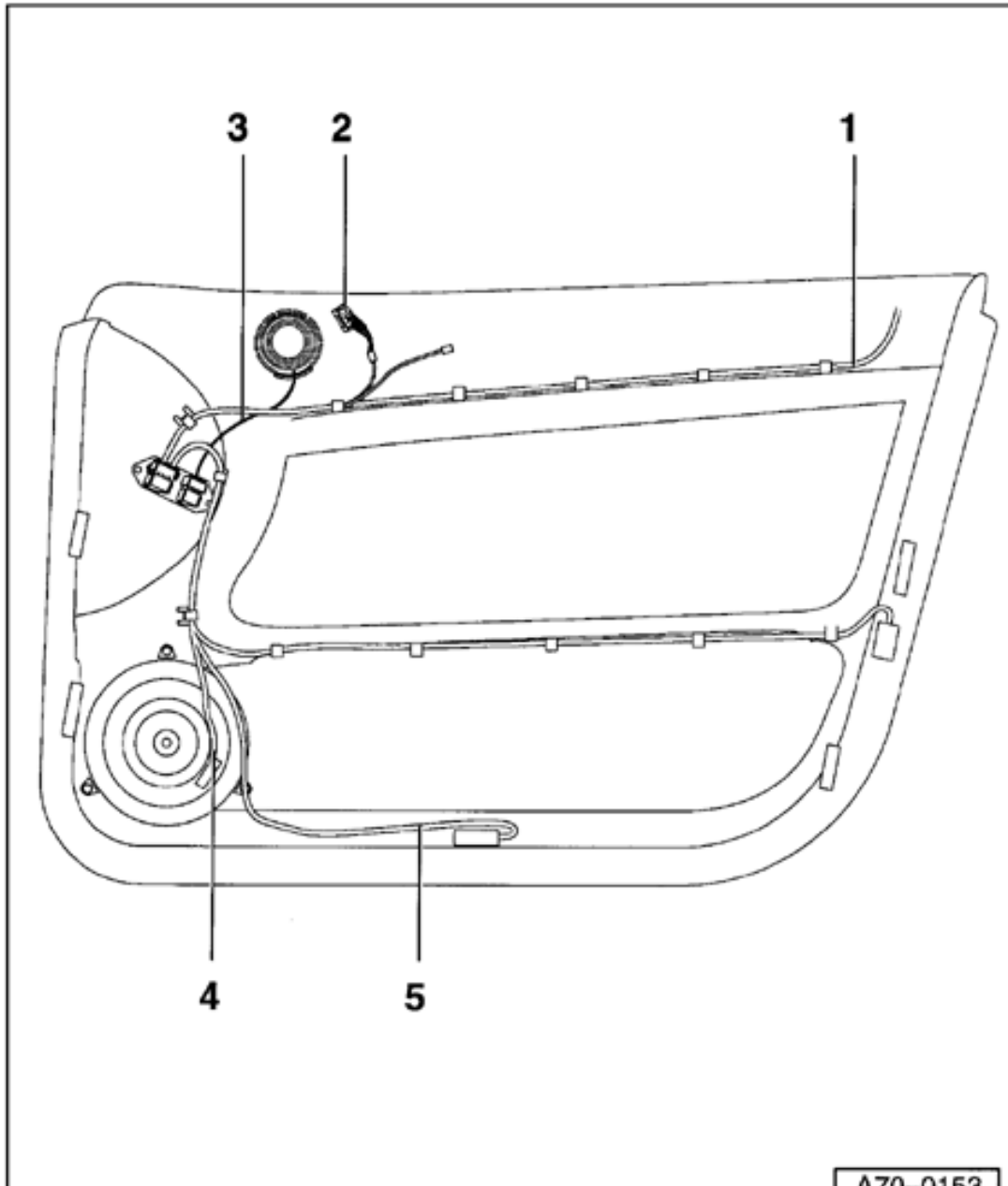

Wiring in door trim, routing

- 1 - Wiring to locking knob guide with light for anti-theft alarm.
- 2 - Wiring to central locking switch (driver's side only).
- 3 - Wiring to treble loudspeaker.
- 4 - Wiring to bass loudspeaker.
- 5 - Wiring to door warning lights.



Door warning light and footwell light, removing and installing

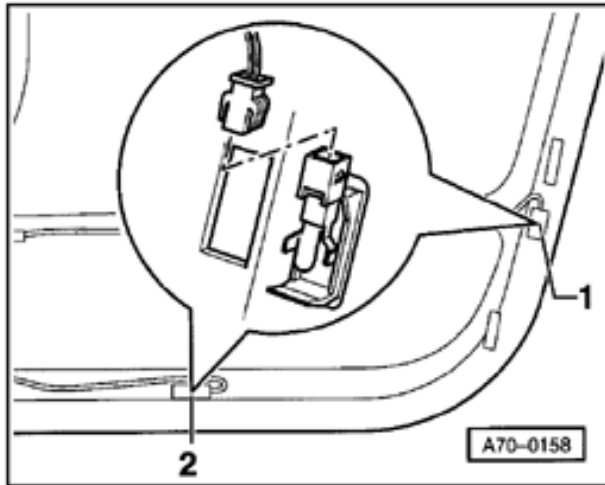

- Use screwdriver to pry out door warning light -1- from underneath and pull outward together with wiring.
- Disconnect door warning light - 1-.
- Use screwdriver to pry out footwell light -2- from front and pull outward together with wiring.
- Disconnect footwell light - 2-.



Treble loudspeaker, removing and installing

- Remove door trim ⇒ [Page 70-3](#).
- Remove insulation ⇒ [Page 70-10](#).

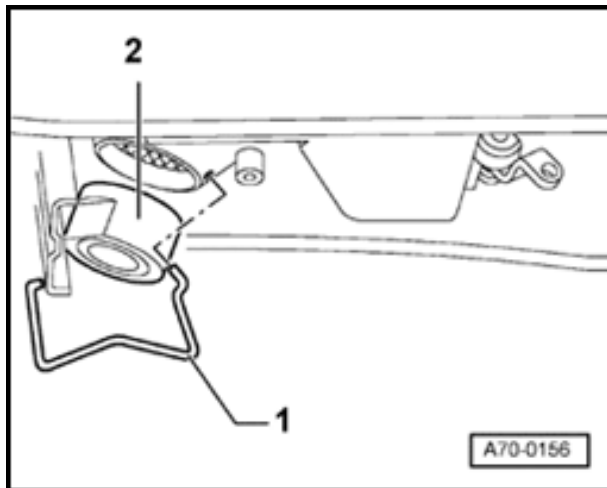

A

- Use screwdriver to detach clip - 1-.
- Remove treble loudspeaker - 2-.
- Detach wiring harness from door trim as far as bass loudspeaker.



Bass loudspeaker, removing

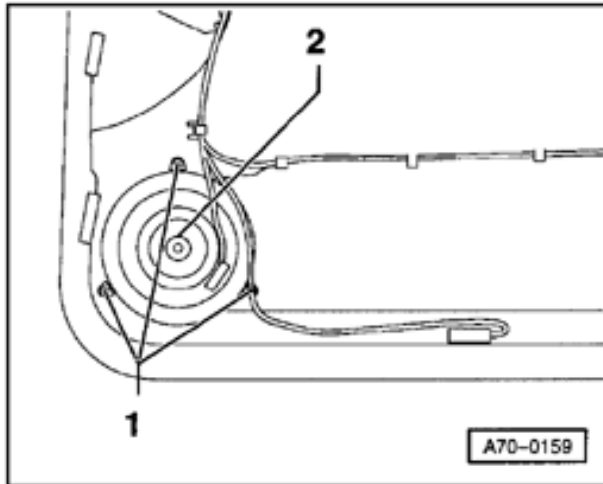

- Remove door trim ⇒ [Page 70-3](#) .
- Remove insulation ⇒ [Page 70-10](#) .
- Remove screws -1- (3x).

Tightening torque: 1.5 Nm (13 in lb)

- Remove bass loudspeaker -2- and disconnect connector.



Hinged pocket assembly, removing and installing

- Remove door trim ⇒ [Page 70-3](#).
- Remove insulation ⇒ [Page 70-10](#).
- Remove screws -1- (6x).

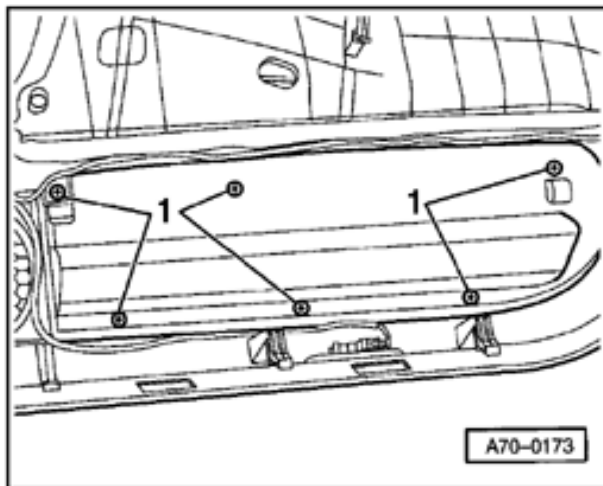

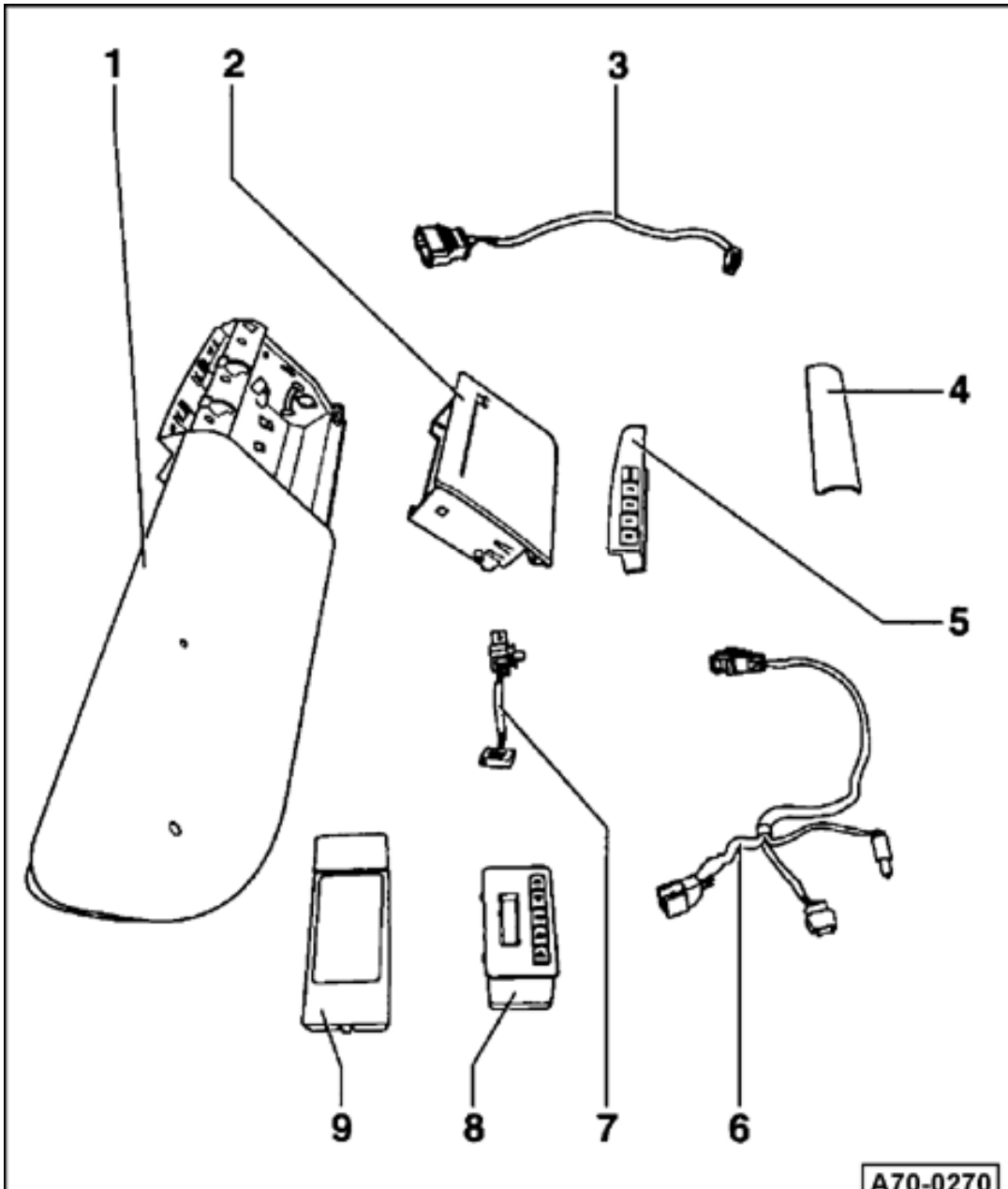

Hinged pocket assembly with memory switch unit and pre-selector/timer for auxiliary heater, overview

- 1 - Hinged pocket assembly
- 2 - Hinged pocket for auxiliary heater pre-selector/timer
- 3 - Wiring for memory switch unit
- 4 - Trim cap
- 5 - Memory switch unit
- 6 - Wiring for auxiliary heater pre-selector/timer
- 7 - Switch for auxiliary heater pre-selector/timer
- 8 - Auxiliary heater pre-selector/timer

A70-0270

9 - Trim panel for
auxiliary heater pre-
selector/timer



Memory switch unit, removing and installing

Removing

- Remove door trim ⇒ [Page 70-3](#).
- Remove hinged pocket assembly ⇒ [Page 70-16](#).

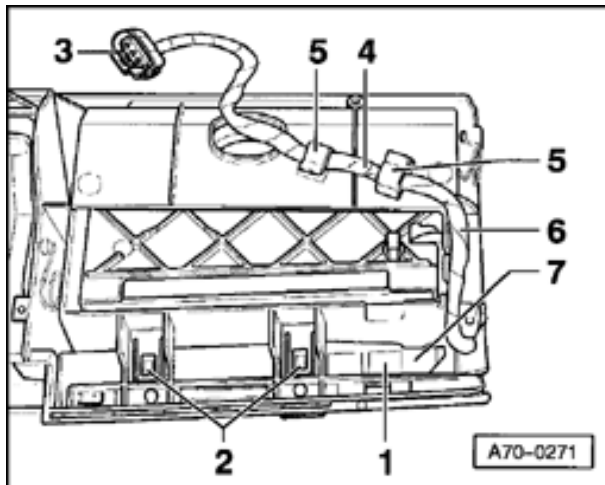

A

- Detach wiring -4- from clips -5- (2x).
- Using a screwdriver, press in retaining lugs -2- (2x) and at the same time push out memory switch unit -1-.
- Disconnect connector -7- from memory switch unit -1-.

Installing

- When installing, make sure that wiring -4- is located in guide -6-.



Trim cap on memory switch unit, removing and installing

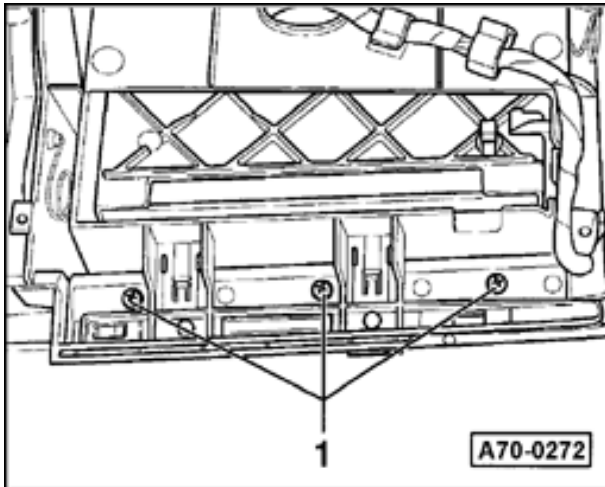

- Remove door trim ⇒ [Page 70-3](#) .
- Remove hinged pocket assembly ⇒ [Page 70-16](#) .
- Remove memory switch unit ⇒ [Page 70-18](#) .
- Remove screws -1- (3x).

Tightening torque: 1.2 Nm (11 in lb)



Pre-selector/timer for auxiliary heater, removing

Removing

- Open flap for pre-selector/
timer.

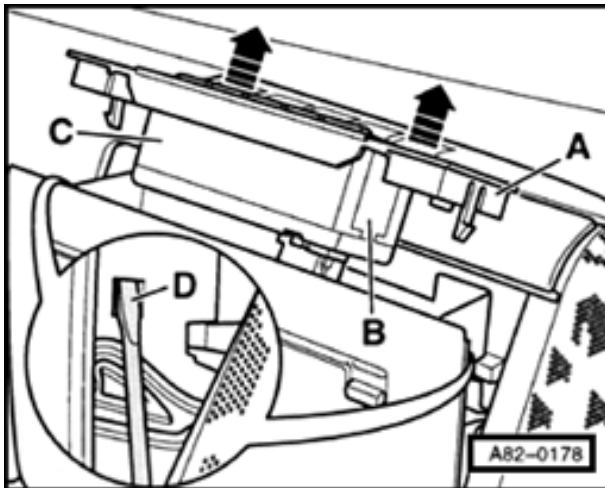

- Using a screwdriver -D-, release catches on sides of
mount -A-.
- Carefully lift mount -A- with pre-selector/timer -C-
out of flap.
- Push pre-selector/timer -C- upward out of mount -
A-.
- Detach
wire.

Note:

*Pre-selector/timer -C- is secured in mount -A- with two
clips -B-.*

Installing

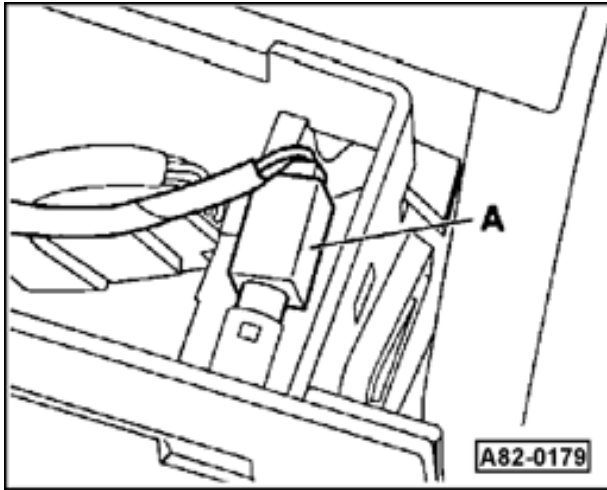

- Install mount -
A-



- Check position of heater indicator lamp -
A-



- Plug in connectors.

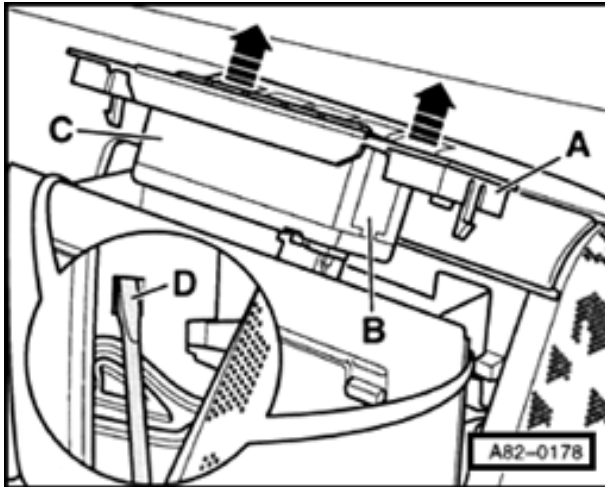

- Install pre-selector/timer -C- in mount -A-.

Note:

- ◆ *When installing pre-selector/timer, make sure that the wiring does not push the pre-selector/timer out of its mount.*
- ◆ *The first vehicles equipped with auxiliary heater were equipped with a preselector/timer unit with Part No. index A. If this unit is replaced with a version with Part No. index C, also replace the mount -A- (which is shaped differently).*



Pre-selector/timer switch, removing and installing

- Remove pre-selector/timer ⇒ [Page 70-20](#) .

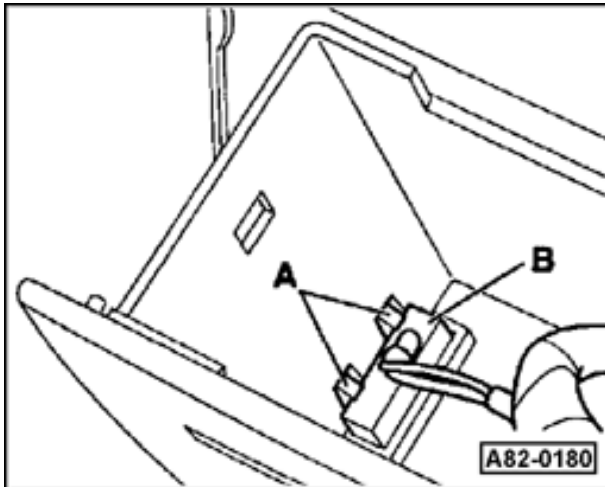

- Using a screwdriver, press back retaining lugs - A-.
- Remove switch - B-.

Note:

- ◆ *Switch -B- is closed when the flap is open.*
- ◆ *The pre-selector/timer is deactivated when the switch is open, which prevents the settings from being altered with the buttons.*



Hinged pocket, removing and installing

Removing

- Remove door trim ⇒ [Page 70-3](#) .
- Remove hinged pocket assembly ⇒ [Page 70-16](#) .

Note:

The hinged pockets can be removed separately.

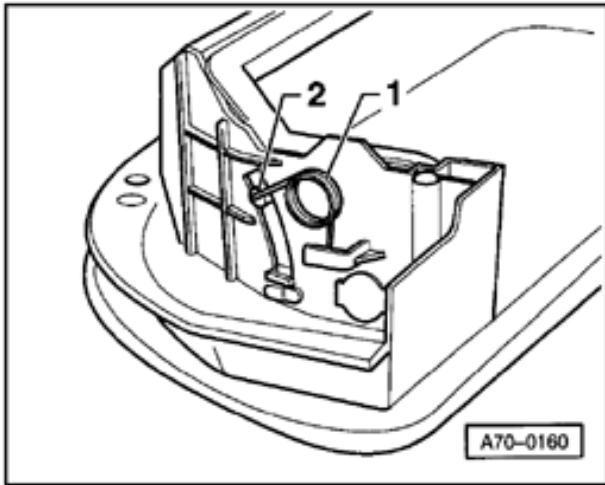

- ↳ - Detach spring -1- from guide - 2-.

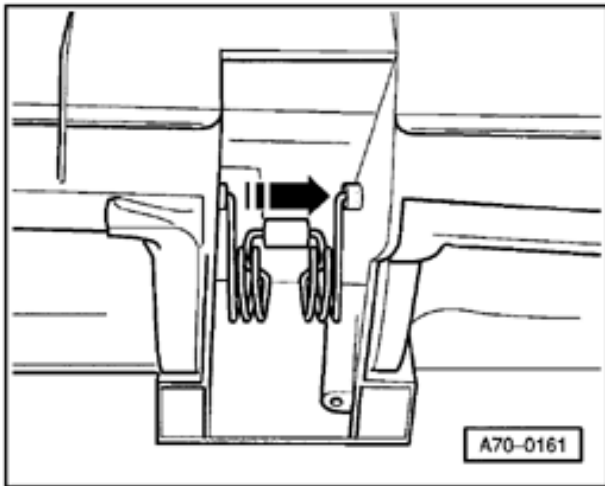

- ↳ - Disengage spring - arrow-.

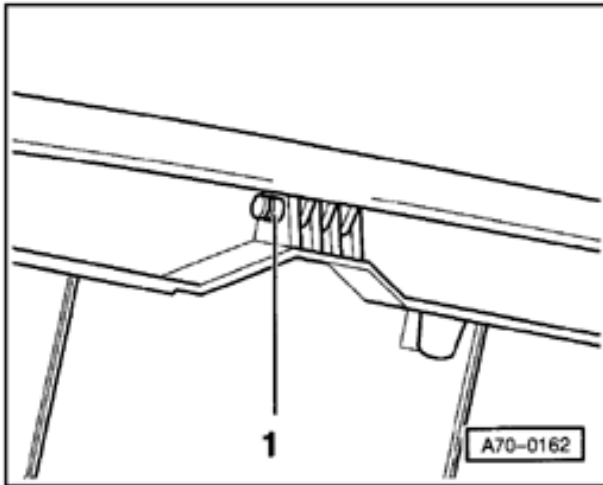

- ▲ - Use screwdriver to press pin -1- outward as far as it will go.
- Use long-nose pliers to pull out pin -1-.

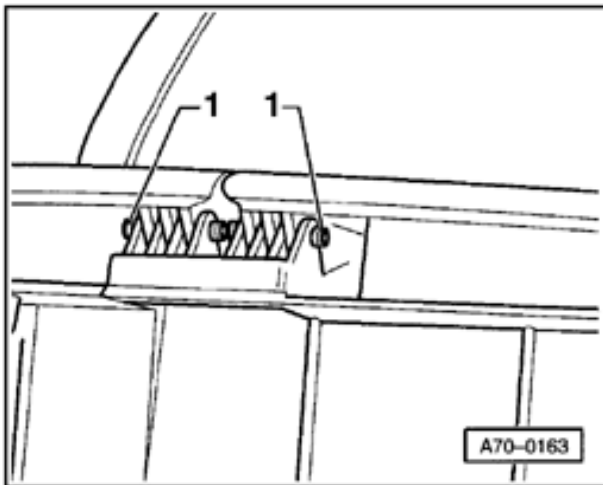

- ▲ - Use screwdriver to press pin -1- outward as far as it will go.
- Use long-nose pliers to pull out pin -1-.

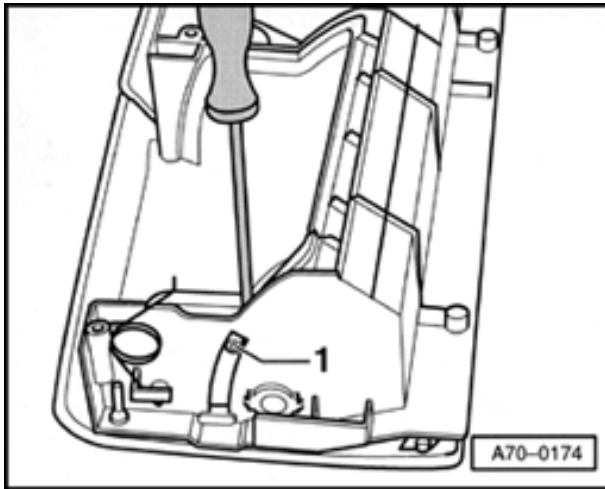

- ▲ - Use screwdriver to pry out guide pins -1- on left and right.
- Remove hinged pocket from mount.

Installing

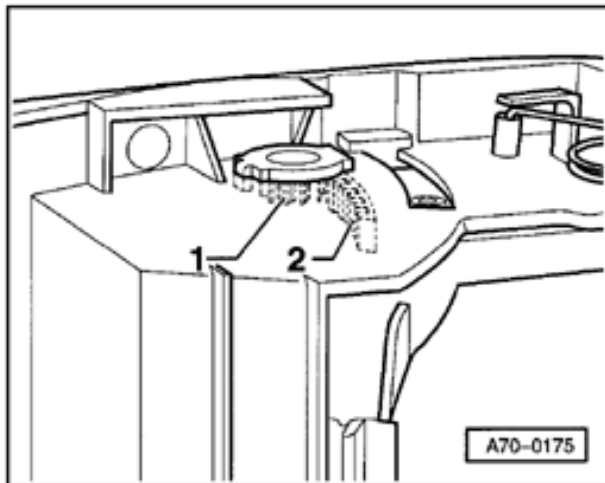

- ▲ - When installing, engage gear wheel -1- in gear track -2-.



Central locking switch, removing

- Remove door trim ⇒ [Page 70-3](#) .
- Remove insulation ⇒ [Page 70-10](#) .

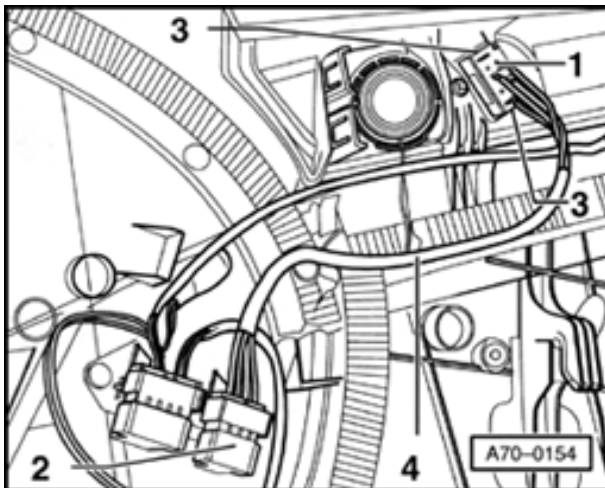

A

- Disconnect connector - 2-.
- Detach wiring -4- from door trim.
- Use screwdriver to press in retainer hooks -3- (2x), and push out central locking switch -1- toward the front.



Trim panel in door trim, removing

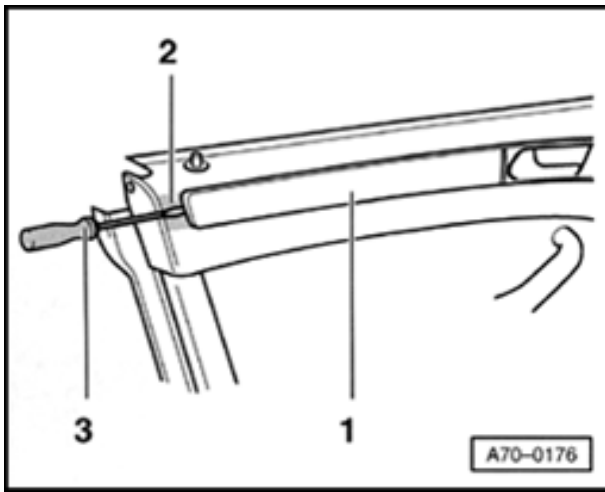

- With door trim installed:
 - Mask door trim with adhesive tape -2- and use screwdriver -3- to pry out trim panel -1-.
- With door trim removed:
 - Push out trim panel from behind by pressing retaining pins.



Interior door handle, removing

- Remove door trim ⇒ [Page 70-3](#) .
- Remove treble loudspeaker ⇒ [Page 70-14](#) .
- Removing central locking switch (driver's side only) ⇒ [Page 70-26](#) .
- A** - Remove screw - 1-.
- Press retainers -2- (2x) and remove interior door handle from the front.

