



Search Audizine

[Home](#) | [News](#) | [Forums](#) | [Classifieds](#) | [Photos](#) | [Videos](#) | [Wiki](#) | [Resource](#) | [Store](#)

User Name    Remember me



***Hello and welcome to the Audizine Forums!***

As a guest, you are welcome to poke around and view the majority of the content that we have to offer, but in order to post, search, contact members, and get full use out of the website you will need to [Register for an Account](#). It's free and it's easy, so don't hesitate to join the Audizine Family today!

If you're new to forums in general, be sure to check out the [Forum FAQ](#). To start viewing posts, select the forum section that you want to visit from the selection below.

- [Forum](#)
- [Main Model-Line Discussion](#)
- [C7 A6/S6/RS6 A7/S7/RS7](#)
- [Fitting Facelift RS7 Grill to your Facelift A/S7 \(Word & Picture Heavy\)](#)

Results 1 to 13 of 13

**Thread: Fitting Facelift RS7 Grill to your Facelift A/S7 (Word & Picture Heavy)**

Be the first of your friends to like this.

Thread Tools    Display

04-26-2016 05:13 PM

#1

**RAF\_S7**   
Senior Member  
Four Rings

**HOW TO: Fitting Facelift RS7 Grill to your Facelift A/S7 (Word & Picture Heavy)**

Guest-only advertisement. Register or Log In now!



**My Photo**  
**Gallery:** 0

Join Date: Mar 29 2014  
AZ Member #: 167502  
Location: Hampshire, UK

### Edit to Section E - Removal of grill /radiator top cover.

This is a guide on fitting the facelift (2016MY) RS7 grill onto the S7. It may also be applied to the A7 S-Line (US Prestige) models which share the S7 bumper. This guide applies only to retrofitting of the Audi RS7 OEM grill.

The RS7 grill is **not** a plug & play installation onto the A/S7 models, and a lot of cutting is required both on the grill itself as well as the bumper its being fitted into.

Given the significant cost of the OEM Audi RS grill, and the associated parts that are required to transfer options such as front facing camera and/or night vision, you undertake this work at your own risk. If you don't feel qualified to undertake this conversion, please engage a competent body shop.

This thread is intended as a guide only.

#### A. Some notes to start:

1. This guide is for fitting the OEM RS7 Grill only. If your fitting an aftermarket (non-OEM) grill, you cannot fit any of the camera options using OEM mounting parts.
2. You do not need to remove the front wheels in order to remove the 2016MY S7 front bumper.
3. You do not need to remove the wheel arch liners or any underbody trays in order to remove the bumper.
4. **Do not start the car or switch on power once you have disconnected any electrical component** such as cameras, parking sensors or ACC radar modules. If you do, the Audi self-check system will register a fault code which you may not be able to clear and could require a dealer visit to reset. VCDS may also be used to reset some fault codes, however the use of VCDS is outside the scope of this guide.
5. This is not a plug and play modification. Total time required around 5/6 hours, depending on your skill level!

#### B. References:

1. A lot of work on the C7/C7.5 platform has already been documented by others, and I highly recommend you read this excellent write up by forum members **Enigma1406** and **Neddy191**. Although RS6 grill specific, it contains a lot of useful information that is also relevant to the A/S7 since they share a common platform. <http://www.audizine.com/forum/showth...all-RS6-Grille>
2. There are a lot of different part numbers, and I've not found a better guide than the online ETKA parts catalogue. Here is a link to the RS7 pages. Grills can be found under "Bodywork". Cameras are under "Electrics" [http://etka.cc/audi/main\\_group/markt...art/765/lang/e](http://etka.cc/audi/main_group/markt...art/765/lang/e)
3. There are a large number of variations of parts, you **MUST** ensure you purchase the right part(s) taking into account what options you have fitted. In the ETKA catalogue, the right hand column "Model Data" references different Audi option codes (use last 3 digits). Use this VAG Decoder to understand which option the part is applicable for to ensure you order the part(s) relevant to your car.

<http://igorweb.org/equidec.aspx>

### C. Tools Required:

1. T20 Torx driver.
2. Flat bladed screwdrivers (Medium and small head).
3. Dremel tool, flexi-shaft, and mini cutting disc, or equivalent type tool.
4. Drill and small drill bits.
5. Bucket (If you have the headlight wash system).
6. Eye protection.
7. Pack of large Ty-Wraps (Zip Ties).
8. Rubber mallet.
9. Trim removal tools are useful, but not essential.

### D. Parts Required:

1. Audi OEM RS7 Grill in a style of your choice.

[http://etka.cc/audi/part\\_single/cata.../256366/lang/e](http://etka.cc/audi/part_single/cata.../256366/lang/e)

2. Rear backing plate for the Audi rings. There are two different part numbers depending on with or without night vision camera.
3. Front plate to mount Audi rings onto. There are two different part numbers depending on with or without front facing parking camera.
4. Left and right mounting brackets for ultrasonic parking sensors (if fitted).
5. Front camera mounting bracket (if fitted).
6. Number plate holder (if required).
7. 2 x Miscellaneous nuts and bolts if you need to fit a number plate.
8. 2 x small self-tapping screws (for fixing parking sensor brackets).
9. Masking tape.
10. Spray primer.
11. Black spray paint.
12. Cardboard box(s) to support bumper while removing connectors

### E. Bumper Removal:

You only need one tool to remove the front bumper – A T20 Torx screw remover.

- Remove the top grill/Radiator cover. Simply remove the centre pins of the two black 'plugs' then pull both plugs out completely.





Now unclip the front edge, and slide the piece forward. (Note that this piece will not fit the RS7 grill, so is not reusable - you will need to purchase the RS7 specific piece)

**Edit:** Just received the RS7 specific top cover, and that doesn't fit either. Rather than mess around with additional purchases, I took the original S7 cover and removed all the front tabs, EXCEPT the two outside ones which clip to the bumper, and refitted. Looks OK. The weight of the hood holds the piece in place.





Put some masking tape on left and right side of the bumper/wing and mark with a pencil. This gives you a reference to ensure original alignment when refitting the bumper.





- Turn front wheels to full lock (Left if your going to unscrew the right hand bumper edge first, or vice-versa).
- Remove the 6 x T20 screws on the edge of the wheel liner as shown below.





- Remove the 5 x T20 screws from the front edge of the underbody engine tray.
- Remove the 2 x T20 screws from the top of the bumper, left and right of the grill.
- On the side of the bumper, grasp the side and pull straight out to disengage from clips. Repeat for opposite side. Your bumper should now look like this:







- Place some cardboard boxes, inline with the bottom of the bumper (assuming one-man job, boxes may not be needed if two-man bumper removal).
- Stand directly in front of the bumper and firmly grasp the existing grill. Pulling directly forward should result in the bumper disengaging from the bodywork.





- Support the bumper (on boxes) while disconnecting the following connections, where relevant to your model:
  - o Parking sensors – single plug assembly on the right hand side (as you face bumper) It's a b\*tch to unplug, as the locking tab is hidden underneath the plug as installed. You can unclip the plug from the bumper and use a small bladed screwdriver to help with separation.





o ACC Radar Module plugs – squeeze side tabs and pull plug up. Repeat for opposite side.





o Headlamp wash (if fitted) disconnect the pipework on the each of the jet assemblies – Squeeze both blue tabs and pull the joints apart. Have a bucket handy, as your about to dump the contents of your washer bottle!





- o Unclip the wash lines from the bumper if required.
- o Unclip and remove camera connector(s) if you have camera options fitted
- You can now completely remove the bumper from the car.

Once you have removed the bumper, the aluminum crash bar will be visible across the front of the radiator. You will need to paint this black, otherwise it will be visible once you fit the RS7 grill. I put 2 coats of primer and three coats of black spray paint on this, while doing the grill modifications, so that it was ready once I finished everything.







**F. Removal of the original grill:**

- Remove the grey foam piece from the back of the grill, disconnecting the parking sensor wires if applicable. You will NOT reuse this foam piece with the RS7 grill.





- Unplug the two parking sensors - pull up on the grey locking tab to unlock, then pull the plug out.
- Remove the two sensors from the grill - push the tabs outwards and pull up on the sensor to release.







- Unscrew all of the perimeter T20 torx screws from the original grill. There may also be 2 X T20 screws behind the rings that require removal - (May only be if you have front parking camera)
- Unlock the original grill tabs. There are two ways to do this: Hard and easy.

o The hard way is pushing on each tab individually while pushing the grill forward to disengage, and working your way around the grill. This will take you at least an hour, probably two with a lot of swearing and frustration.

o The easy way is pushing on each tab using the flat blade screwdriver and inserting a ty-wrap to keep the tab from reseating in the bumper frame. Repeat this for every tab until you have a ty-wrap inserted into each tab. Using a rubber mallet, gently hit tabs to disengage the grill. This will take you at least 10 minutes with no swearing or frustration!



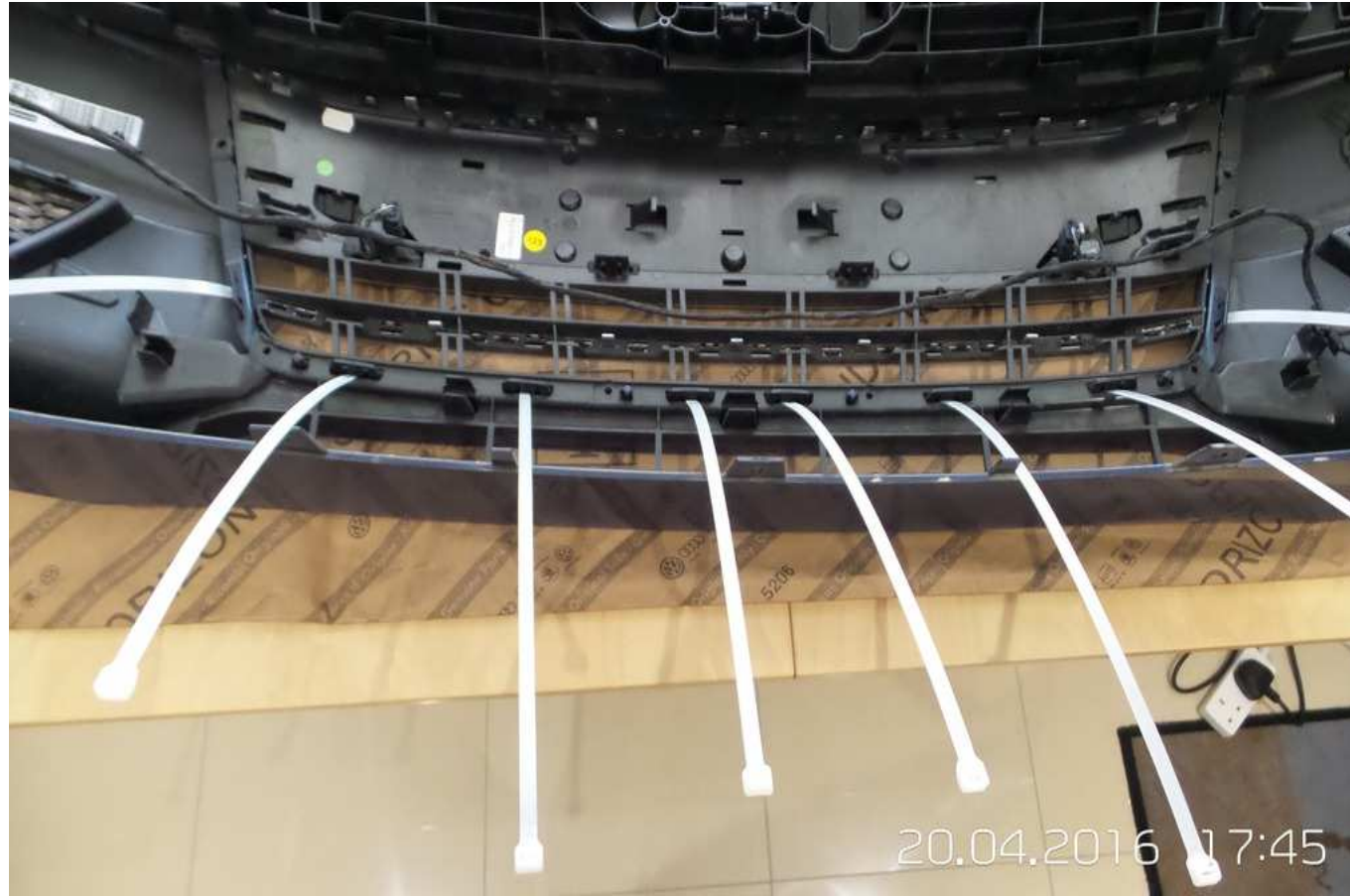



**G. Modification of the RS7 Grill:**

If you place the S7 and RS7 grill next to each other, it quickly becomes obvious that the RS7 grill uses a completely different mounting system to the S7 Grill.





There are no locking tabs on the RS7 grill, only mounting pegs (to guide alignment) and T20 Torx screw mounting points. The only useable screw mounting points are the 6 across the top of the grill, and the bottom left and bottom right ones. Everything else must be removed – pegs and screw mounting points.

Remove the Red Circle items, **KEEP** the Green ones





Alignment of the original S7 grill is through the use of the lock tabs on the grill itself, and the alignment tabs located around the bumper opening. Each of the bumper tabs locates into the channel that runs around the outside of the original S7 grill.

On the RS7 grill, the channel that runs around the outside of the grill is effectively blocked in a number of places by the location pegs and additional screw mounting points. It is absolutely essential that when removing the surplus pegs and screw points that they are removed entirely, including right down inside the channel. This is where the use of the flexi-shaft on the Dremel is invaluable. If the channel is not entirely clear, or you leave any trace of the original pegs and screw points, they will interfere with the fitment of the RS7 grill, making alignment impossible.



Please refer to Neddy191's post #49 for a picture of what a screw point must look like after removal.  
<http://www.audizine.com/forum/showth...6-Grille/page2>

You will likely have to test fit the RS7 grill onto the bumper a number of times to ensure correct alignment. Where it is not sitting correctly, check for any further cutting required then refit. I found working from the bottom of the grill to the top was the most effective way to do this. A flashlight and a pencil are useful tools to use in order to mark where you need to check/cut.

For the bottom two screws, I found they did not align with the original screw holes in the bumper, and that the tab on the actual bumper interfered with a flush fit. I cut the bumper tab(s) at this point in order to facilitate the

the only lower mounting points that you are going to use on the grill.



If you have a front parking camera to fit, now is the time to modify the RS7 grill in order to accommodate the camera mounting bracket. Cut the grill using the camera mounting bracket as a guide. Just remember the camera is pointing slightly downwards when mounting the bracket. The area that you cut will be covered by the front Audi ring mount, which has the front camera cover integrated on to the actual mounting.







You can now go ahead and mount the Audi rings front & rear brackets and camera mounting bracket to the grill. For the camera bracket, use a couple of the T20 screws you removed from the original S7 grill to mount to the grill.







If you have the night vision camera, you should now mount this also (I do not have the NV camera, so can't comment on the mounting process)

The RS7 grill does not have integrated parking sensor fittings. You need to fit the two sensor brackets. Location of the brackets is pretty obvious; however, you do have to modify the brackets by completely removing the "U" shaped plastic on the outer edge.

I secured the brackets using a small (short) self-tapping screw. There is also a tab on the grill which the bracket slips over. I also put a securing clip over the tab.



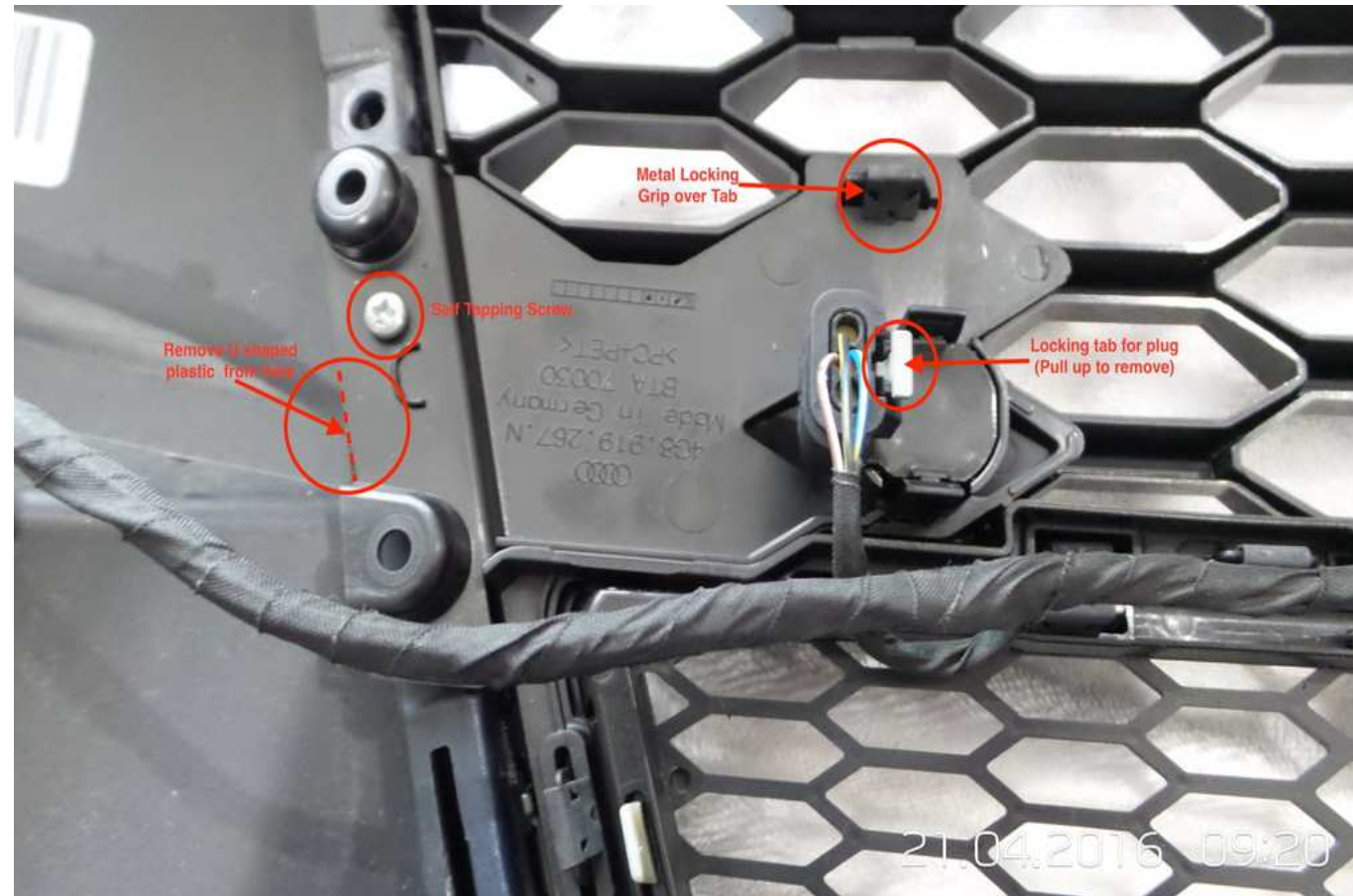

If you're A/S7 has the black optics pack, then the parking sensors will already be coloured black. If they are grey, simply remove the rubber grommet from the sensor and spray paint them black. Two coats (no primer) was plenty. Allow to dry then push fit into the mounting points you have just fitted. You can now reconnect the cables to the sensors and tidy the wires up.





Now is the time to mount your number plate bracket if required.

#### **H. Mounting the RS7 Grill into the S7 Bumper:**

Once you are satisfied with the fit and alignment of the RS7 grill, you can now secure the grill to the bumper. You can reuse the T20 screws recovered from removing the original grill.

4 of the top screw points align with exiting holes in the bumper and can simply be screwed together. Two screw points did not align with any existing holes, however I felt that the RS7 grill was very securely fastened at this point, so elected not to drill the remaining two holes (giving 6 screws across the top of the grill) If you want to drill the two additional screw holes feel free.

Fit the bottom two T20 screws using the new holes you drilled earlier.

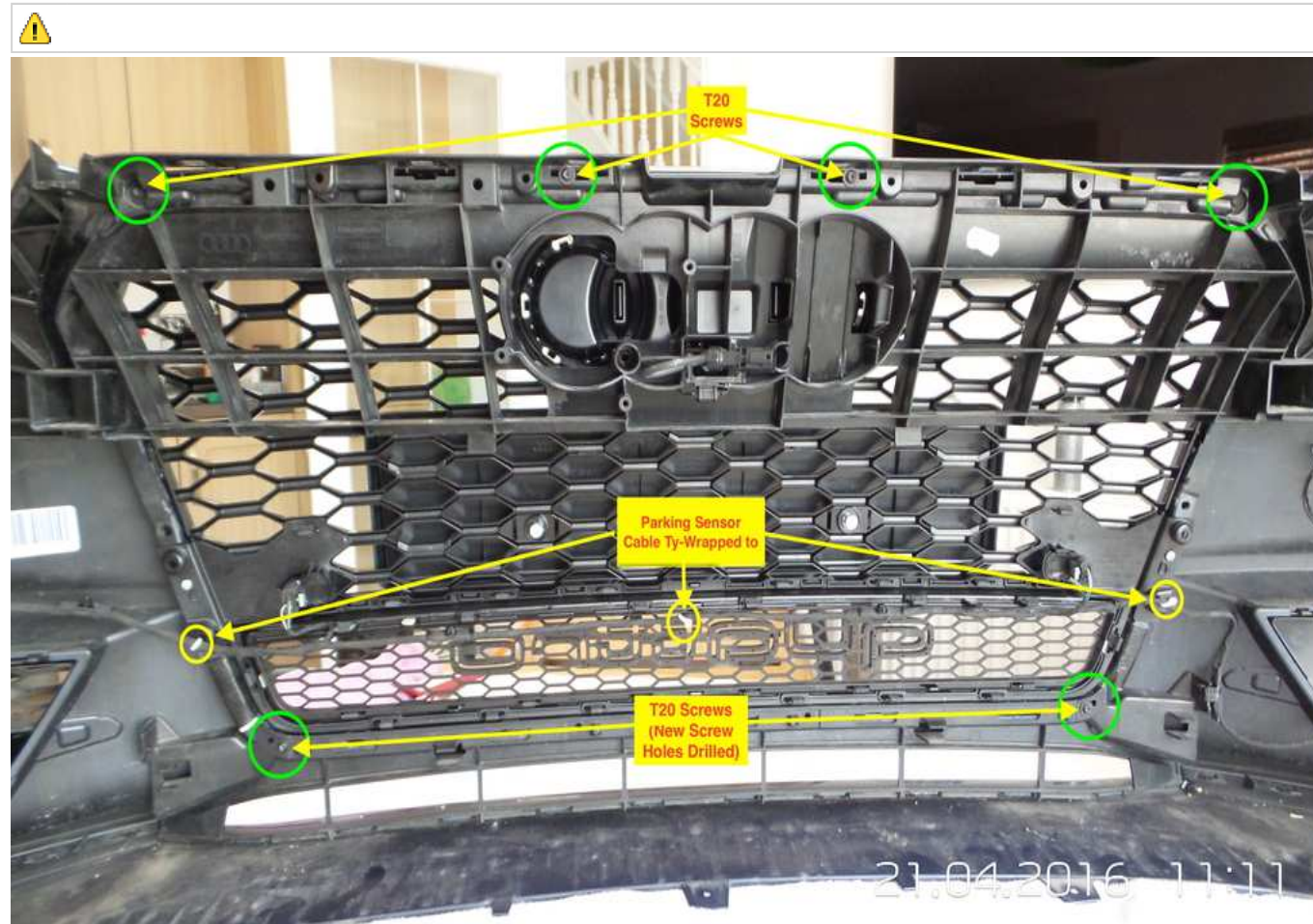

In my opinion, the use of only 6 screws in total (4 x top and 2 x bottom corners) is sufficient to hold the grill in place securely. You may want to use 6 on top by drilling holes for the other two mounting points, but that's your call. The grill is not going to go anywhere once mounted!

Refitting the Bumper to the car:

This is obviously the reverse procedure used when you took the bumper off.

It's a very easy re-install, and you should have no issues with alignment of the bumper to the bodywork.

Once you reconnect ACC/Parking Sensors/Headlamp wash lines, you simply align the 2 x bumper mounting pegs and sockets.

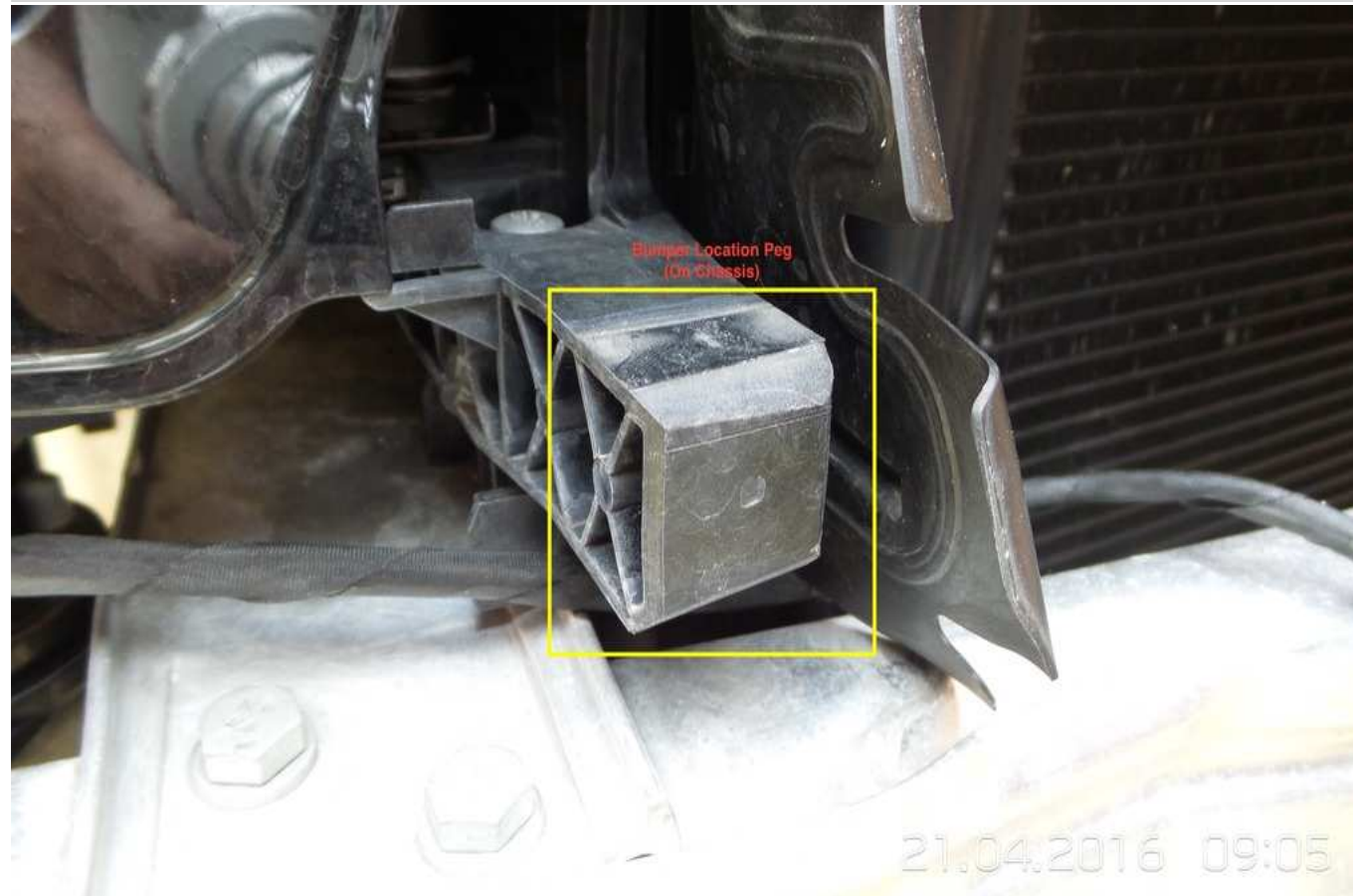



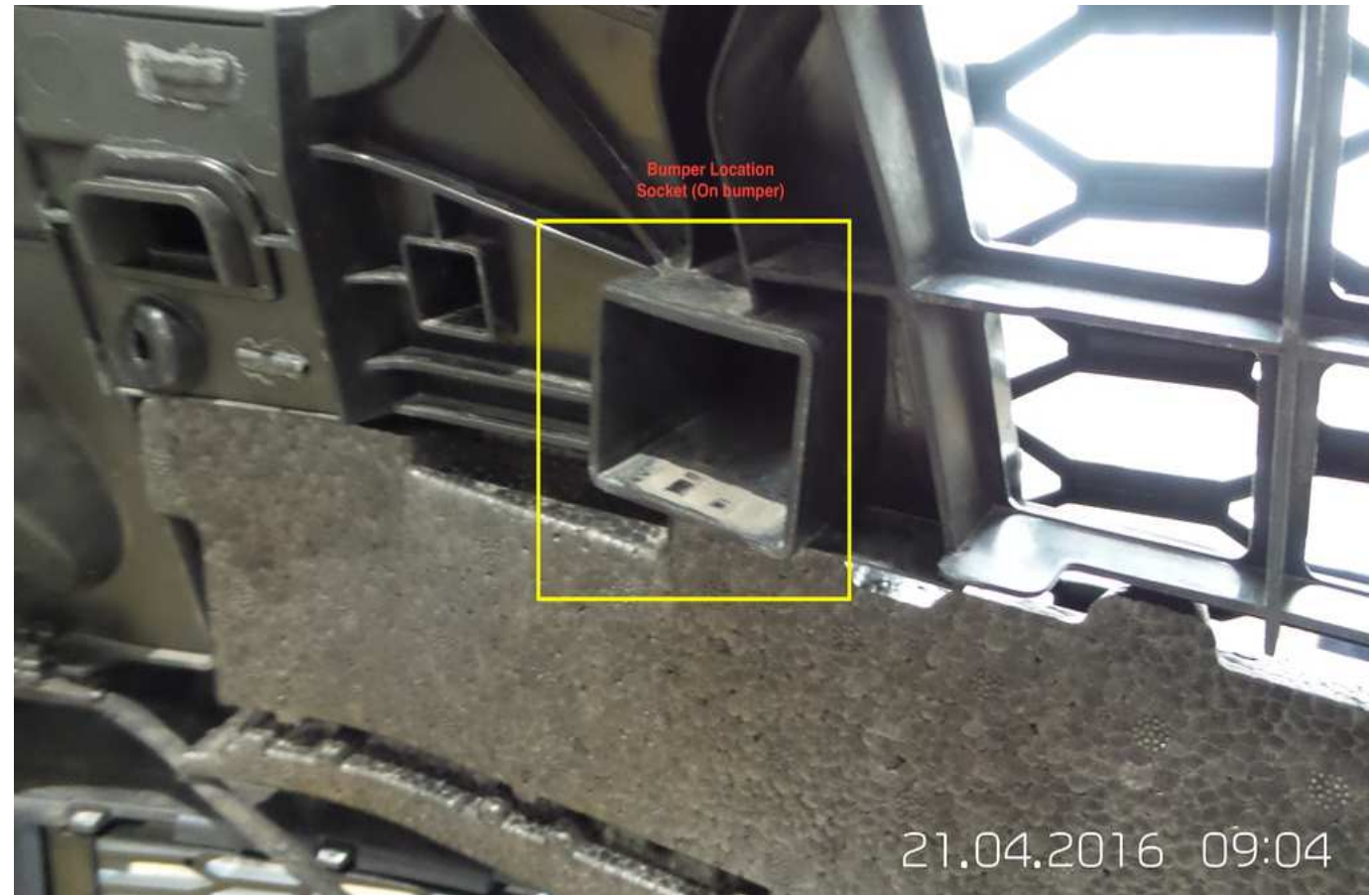

Ensure you align the bottom bumper screw holes with the front of the bottom engine cover tray. The blank tabs go on top, the screw tabs go underneath.

Push the grill/bumper firmly and ensure the two top tabs are properly located with the screw mounting points either side of the radiator.

At this stage the bumper should be well aligned. Ensure the bumper is fully pushed back in order to have the sides correctly aligned and fitted over the side mounting points under the wheel arch liner. Now press the top of the bumper side into place (may need a hard push or tap with your fist) It will "snap" into place.

The bumper is now fully fitted, and you can check alignment using the masking tape and marks you put in place earlier.

Reinsert all T20 screws removed earlier:

- 2 x small head T20s either side of the radiator
- 5 x T20s to secure the lower engine cover
- 5 x T20s to secure wheel liners to the grill (both sides)
- 1 x T20 (vertically) to secure top corner of bumper to the wing (both sides)

Start the car and ensure there are no fault codes indicated. (I had no faults or alignment issues after refitting. ACC worked just fine)

Stand back and admire your new front.

Note that the S7 grill badge cannot be attached to the RS7 grill due to the different mounting solution. So stay in stealth mode, or masquerade as an RS7!

Job completed!

*Last edited by RAF\_S7; 12-27-2016 at 11:18 PM.*

**2016 S7 Sepang Blue** ///Matrix//Bose//HUD//Self Park//Lane Assist//ACC//F&R parking cams//Blackvue DR650//Phone Box//Sunroof//Privacy glass//Carbon Trim//Carbon mirrors//Neidfaktor Carbon Steering wheel//RS Knob//OEM RS Grill//Suntek PPF//De-chromed//Roc-Euro//Modded Exhaust//Cete ASC v2 installed  
**Gone:** 2014 Audi A7Q 3.0 TFSI  
**Gone:** 2011 Audi A6Q 2.8 TFSI  
**Gone:** 2009 Audi A3Q 2.0 TDIi

Reply With Quote

- [Details ▶](#)
- [Details ▶](#)
- [Details ▶](#)
- [Details ▶](#)
- [Details ▶](#)



04-26-2016 05:15 PM

#2

**RAF\_S7** ◉

Senior Member  
Four Rings



Join Date: Mar 29 2014  
AZ Member #: 167502  
Location: Hampshire, UK

**My Photo Gallery:** 0

The finished article:







**2016 S7 Sepang Blue** ///Matrix//Bose//HUD//Self Park//Lane Assist//ACC//F&R parking cams//Blackvue DR650//Phone Box//Sunroof//Privacy glass//Carbon Trim//Carbon mirrors//Neidfaktor Carbon Steering wheel//RS Knob//OEM RS Grill//Suntek PPF//De-chromed//Roc-Euro//Modded Exhaust//Cete ASC v2 installed  
**Gone:** 2014 Audi A7Q 3.0 TFSI  
**Gone:** 2011 Audi A6Q 2.8 TFSI  
**Gone:** 2009 Audi A3Q 2.0 TDIi

**Reply With Quote**

04-27-2016 01:38 PM

#3

**Keaney** Established Member  
Two RingsJoin Date: Oct 09 2014  
AZ Member #: 287923  
Location: UK**My Photo Gallery:** 0

Great write up... Looks a little harder on the facelift with more holes to remove from the grill!

Sent from my iPhone using Tapatalk

**Reply With Quote**

04-27-2016 01:58 PM

#4

**zee007** Veteran Member  
Four RingsJoin Date: Jan 12 2010  
AZ Member #: 53290  
My Garage: 2016 RS7;  
2017 X5M  
Location: RVA**Items for Sale****My Photo Gallery:** 0

That is the most comprehensive write up I have ever seen. Nice one.

**- Zee**Gone: MY16 RS7 | Nardo | Diamond | Carbon Optic | Sport Exhaust | Eurocode | 034M | H&R | TAG | K&N  
Past: [MY09 TT](#) | [MY10 S5](#) | [MY13 AllRoad](#) | [MY15 S6](#)

Current: MY17 BMW X5M | Loaded | Quick | Brute | Not an Audi

**Reply With Quote**

04-27-2016 02:01 PM

#5

**Djpeaksd** 

Established Member  
Three Rings



Join Date: Feb 01 2016  
AZ Member #: 368088  
Location: Encinitas, CA

**My Photo Gallery:** 0

Great write up, thanks for sharing! Looks like I am keeping my grille!!!!

**2016 S7 Sepang Blue**, Sport, Black Optic, Driver Assistance packages. EPL ECU & TCU tune, 21x10.5 TSW Bathurst wheels, Roc-Euro intake, and resenator delete, OEM RS grille with Quattro script.

**Reply With Quote**

04-27-2016 11:35 PM

#6

**shamus\_mcd** 

Active Member  
Two Rings



Join Date: Dec 17 2013  
AZ Member #: 136367  
Location: Lanarkshire near Glasgow

**My Photo Gallery:** 0

Put this on a sticky

Reply With Quote

04-28-2016 06:44 AM

#7

**maximusBH** ◊

Established Member  
Two Rings



Join Date: Apr 15 2016  
AZ Member #: 371895  
Location: France

**My Photo Gallery:** 0

Originally Posted by **jkwelsh**

*The finished article:*









Fantastic car and fantastic write up...you know already this write up will be very helpful! Thanks

Envoyé de mon SM-G920F en utilisant Tapatalk

**Reply With Quote**

04-30-2016 12:15 PM

#8

**neddy191** ◉

Established Member

Great write up. Glad my posts in the older thread have been helpful.

Two Rings



Join Date: Dec 30 2014  
AZ Member #: 306739  
Location: NC

**My Photo Gallery:** 0

---

2016 S6 (Daytona Gray)

**Reply With Quote**

05-17-2017 05:50 AM #9

**sd761** 

Established Member  
Two Rings  
Join Date: May 09 2014  
AZ Member #: 215434  
Location: Delco

**My Photo Gallery:** 0

 Originally Posted by **RAF\_S7** 

*The finished article:*









Raf just a thought once you remove front bumper and parking sensors is it mandatory that you remove all other components. What I mean is that if you have enough room to work with the bumper without unhooking " everything" is that feasible?

Sent from my iPhone using Tapatalk

**Reply With Quote**

05-17-2017 08:05 AM

#10

**RAF\_S7** ◉Senior Member  
Four RingsJoin Date: Mar 29 2014  
AZ Member #: 167502  
Location: Hampshire, UK**My Photo Gallery:** 0Originally Posted by **sd761** ◉

*Raf just a thought once you remove front bumper and parking sensors is it mandatory that you remove all other components. What I mean is that if you have enough room to work with the bumper without unhooking "everything" is that feasible?*

If you mean can you work on the grill without removing the bumper from the car, I wouldn't recommend it. Space will be tight, and there is a lot of cutting to be done to get the RS grill and bumper to fit together correctly.

On the A7 Prestige, without ACC but with parking sensors, there really should be anything other than the parking sensors to disconnect. From what others have said, the US market does not have the headlamp power washers.

My biggest recommendation is that before you cut anything, check that the A7 Prestige bumper can carry the RS7 grill.

Good Luck!  
John.

**2016 S7 Sepang Blue** ///Matrix//Bose//HUD//Self Park//Lane Assist//ACC//F&R parking cams//Blackvue DR650//Phone Box//Sunroof//Privacy glass//Carbon Trim//Carbon mirrors//Neidfaktor Carbon Steering wheel//RS Knob//OEM RS Grill//Suntek PPF//De-chromed//Roc-Euro//Modded Exhaust//**Cete ASC v2 installed**  
**Gone:** 2014 Audi A7Q 3.0 TFSI  
**Gone:** 2011 Audi A6Q 2.8 TFSI  
**Gone:** 2009 Audi A3Q 2.0 TDIi

**Reply With Quote**

05-17-2017 08:09 AM

#11

**sd761** ◉Established Member  
Two RingsJoin Date: May 09 2014  
AZ Member #: 215434Originally Posted by **RAF\_S7** ◉

*If you mean can you work on the grill without removing the bumper from the car, I wouldn't recommend it. Space will be tight, and there is a lot of cutting to be done to get the RS grill and bumper to fit together correctly.*

Location: Delco

**My Photo Gallery:** 0

*On the A7 Prestige, without ACC but with parking sensors, there really should be anything other than the parking sensors to disconnect. From what others have said, the US market does not have the headlamp power washers.*

*My biggest recommendation is that before you cut anything, check that the A7 Prestige bumper can carry the RS7 grill.*

*Good Luck!  
John.*

Thanks John. Appreciate it. It looks like a perfect fit on size so worse case remove bumper and grille and test fit it. Thanks friend.

Sent from my iPhone using Tapatalk

**Reply With Quote**

05-17-2017 08:12 AM

#12

**RAF\_S7** ◻

Senior Member  
Four Rings



Join Date: Mar 29 2014  
AZ Member #: 167502  
Location: Hampshire, UK

**My Photo Gallery:** 0

Originally Posted by **sd761**

*Thanks John. Appreciate it. It looks like a perfect fit on size so worse case remove bumper and grille and test fit it. Thanks friend.*

Look forward to seeing the before and after pictures 🛠️😊

**2016 S7 Sepang Blue** ///Matrix//Bose//HUD//Self Park//Lane Assist//ACC//F&R parking cams//Blackvue DR650//Phone Box//Sunroof//Privacy glass//Carbon Trim//Carbon mirrors//Neidfaktor Carbon Steering wheel//RS Knob//OEM RS Grill//Suntek PPF//De-chromed//Roc-Euro//Modded Exhaust//Cete ASC v2 installed  
**Gone:** 2014 Audi A7Q 3.0 TFSI



**Gone:** 2011 Audi A6Q 2.8 TFSI  
**Gone:** 2009 Audi A3Q 2.0 TDIi

[Reply With Quote](#)

05-17-2017 08:25 AM

#13

**sd761** 

Established Member  
Two Rings

Join Date: May 09 2014

AZ Member #: 215434

Location: Delco

**My Photo Gallery:** 0

### Fitting Facelift RS7 Grill to your Facelift A/S7 (Word & Picture Heavy)

 Originally Posted by **RAF\_S7** 

*Look forward to seeing the before and after pictures* 

Let me know when your finished with my car and send me pics ! Haha. Just kidding. I'm going to do it! Can't wait! Cross your fingers 

Sent from my iPhone using Tapatalk

*Last edited by sd761; 05-17-2017 at 11:34 AM.*

[Reply With Quote](#)

Quick Navigation

[C7 A6/S6/RS6 A7/S7/RS7](#)

[Return](#)

[Top](#)

[« Previous Thread](#) | [Next Thread »](#)

**Bookmarks**

-  Digg
-  del.icio.us
-  StumbleUpon
-  Google

**Posting Permissions** 

You may not post new threads	<b>BB code</b> is On
You may not post replies	<b>Smilies</b> are On
You may not post attachments	<b>[IMG]</b> code is On
You may not edit your posts	<b>[VIDEO]</b> code is On
	HTML code is Off

**Forum Rules**

[Contact Us](#) [Forum Home](#) [Archive](#) [Top](#)

All times are GMT -7. The time now is 09:34 AM.